

CANTILEVER RACK

Designed to easily store and retrieve products with varying weights, lengths, and sizes. Cantilever systems do not require uprights, allowing for easy product accessibility and selectivity paired with high down-aisle density. Cantilever systems offer easy arm adjustability, providing a full range of loading capabilities that can be customized to your storage application.

Ideal applications: Long or bulky items such as lumber, furniture, and plumbing.



SPECIFICATIONS & OPTIONS

STRUCTURAL CANTILEVER RACK

- Fastened through a high-strength bolted connection
- Arm lengths for storage depth can range from 24" to 72" per shelf
- Adjustable on 4" centers
- 3 arm slope options
- Towers are designed to match your height requirements
- Decked-arm shelf-configuration is available with wire-mesh deck, plywood platforms, or specialized steel decking
- Aisle guidance systems are available
- Entry guides are available

ROLL FORMED CANTILEVER RACK

- Fastened through a bracket pin connection
- Arm lengths for storage depth can range from 24" to 72" per shelf and are adjustable vertically on 3" centers
- Towers are designed to match your height requirements
- Decked-arm shelf-configuration available with wire mesh deck, plywood platforms, or specialized steel decking
- Aisle guidance systems are available
- Entry guides are available

ARM OPTIONS

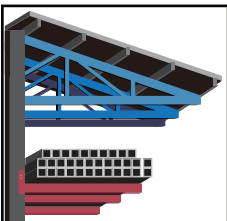

Roof Supports

Attaches to arms to accept stringers for roof structure.

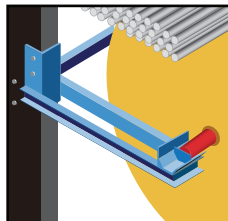

Core/Axle Saddles

Attaches to arms for accepting core/axle of rolled materials.

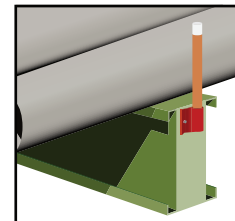

Removable Pipe End Stops

Attaches to arms or base, includes pipe, bracket and plastic caps

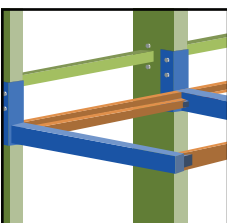

Deck Support Saddles

Attaches to arms. Used for decking supports.

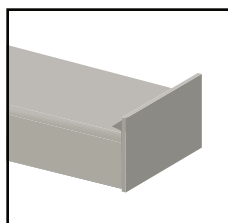

Welded-on End Lips

Welded to arms or base. Many heights available.

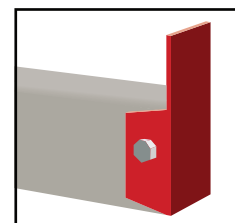

Bolted-on End Lips

Arms punched to accept optional removable end lip.

RACKING OPTIONS

STRUCTURAL STEEL RACK

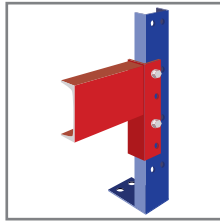
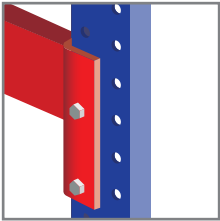
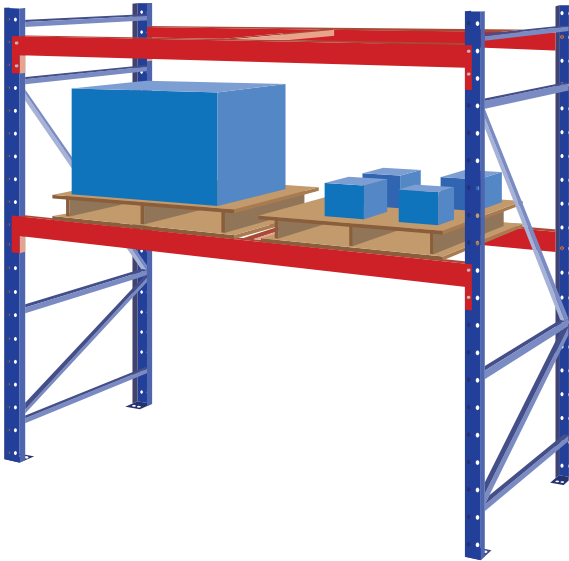

- Very strong, able to hold very heavy loads.
- Ideal for high traffic and forklift impact prone areas.
- Ideal for outdoor storage and freezer storage.
- Beams are bolted to the uprights.
- Formed with an open back and is therefore easy to keep debris-free. This makes structural steel rack ideal for food storage applications.
- Can be designed as a selective system, flow system, push back system, and drive-in and drive-through systems.



ROLL FORMED STEEL RACK

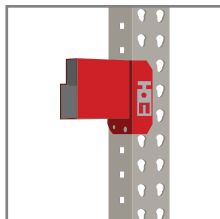
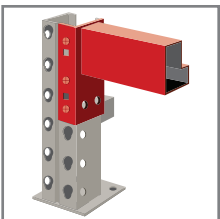
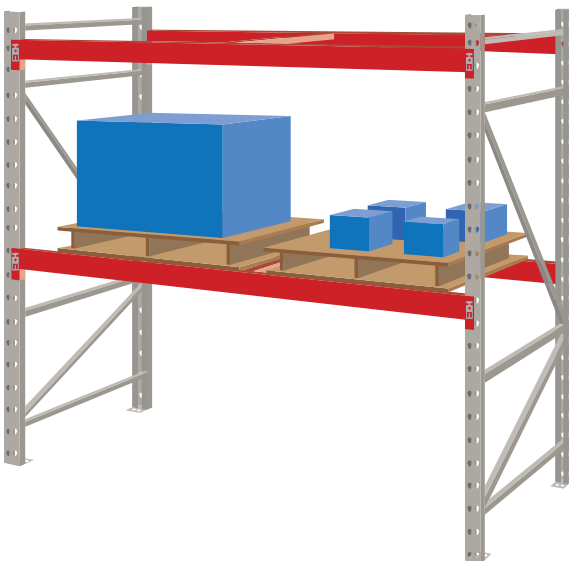

- Can produce many different shapes, making it ideal for various engineered solutions.
- Less expensive than structural.
- Ideal for most standard warehouse applications.
- Allows for easy adjustability, reconfiguration, and relocation.
- Most commonly manufactured as teardrop style.
- Beams are attached to uprights by inserting the raised portion of the beam into the corresponding hole on the upright and secured with safety locks.
- Can be designed as a selective system, flow system, push back system, and drive-in and drive-through systems.



PROJECT MANAGEMENT

REB Storage Systems International's large project management department is unparalleled in terms of product knowledge and project experience. REB's project manager will be the single point of contact throughout every phase of the project, including assessment, design, manufacturing, installation, permitting, testing, and completion.

The experience and skills of our project managers ensure the ultimate success of your project. They'll manage all sub-contractors and continuously monitor the progress of the entire project so that it is completed on time and within budgetary guidelines.

Our project management services are available for all projects, large or small.

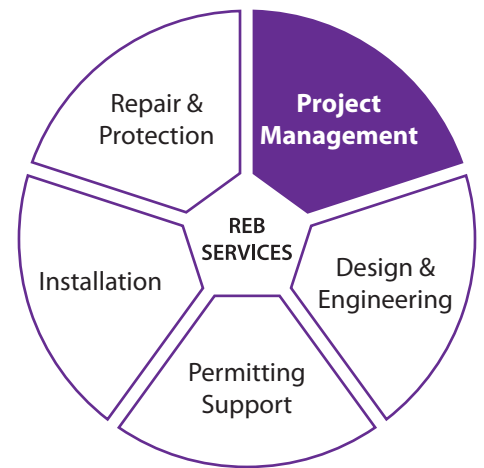

"We use REB because we're comfortable with the product that they deliver, we're comfortable with their design and installations that they recommend to maximize our business."

- Richard Steed, Pacific Records Management

PLANNING & MONITORING

Proper planning and communication is key to the successful completion of every project. REB project managers obtain commitments on lead times for all materials and set a project schedule, highlighting all milestones and producing a firm completion date.

This schedule is then communicated to all stakeholders as needed including customers, vendors, contractors, building officials, and internal resources to ensure that all have an understanding of the scope of the project. Weekly updates are also provided to keep the project on-track.

SUBCONTRACTOR MANAGEMENT

REB project managers evaluate all subcontractor and manufacturer bids based on lead time, quality, and price with the intention of retaining high-quality services and products while reducing overall costs and project completion time.

FREIGHT MANAGEMENT

We manage the logistics of all materials, often from various distribution points. REB project managers work with multiple freight brokers to ensure that you received the best value on your freight.

PROJECT CLOSING

Once the project is completed, the project manager will perform a final walkthrough of your system with you to confirm the quality of the installation and the conformance to the system specifications.

DESIGN & ENGINEERING

To maximize storage and ensure that traffic can move efficiently through your facility requires careful planning.

REB's engineering team is backed by over 53 years of storage system design experience in a wide variety of settings. No matter what the needs of your space, we can create the professionally engineered solution that will help you manage your inventory.

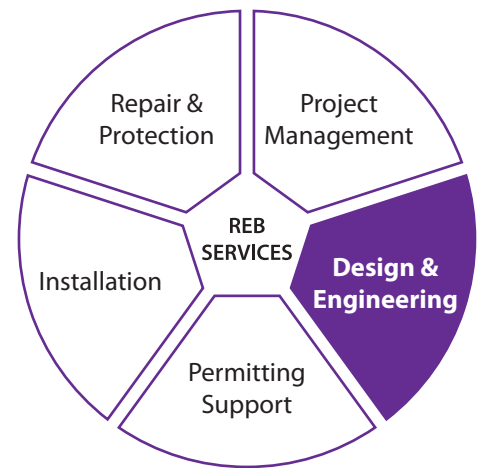

FACILITY LAYOUT & SYSTEM ENGINEERING

Our services begin with a full assessment of your warehouse, taking into account the layout of your space, the characteristics of your inventory, and the material handling equipment that your team uses.

Our project engineers then utilize Computer Aided Design (CAD) to produce detailed drawings that enable us to review various designs to ultimately create the plans for your storage system that will facilitate the success of your project and your operations.

We'll conduct the research necessary to ensure that our designs comply fully with the federal, state and local regulations that govern your area to make obtaining the necessary permits a simpler task.

COMPLETE SYSTEM INTEGRATION

REB product integration experience, fabrication knowledge, and manufacturer relationships deliver turn-key storage system solutions for our customers.

REB engineers work with sprinkler and electrical contractors to include required information on rack drawings as required by local and federal regulations specific to your storage system size and layout.

Our designs can integrate material handling equipment in the best possible locations within your storage system to optimize your storage and retrieval process. This can include conveyors, chutes, hoists, and other equipment.

We have been using REB since 2009 and we have found the level of innovation, services and completion of work to be above standards previously set by other vendors. From the initial project concept to design, the actual product and service delivery, the standard of client care is second to none and a REB representative is always available when necessary. REB has also reviewed past installs and found ways to create more density and efficiencies which we have then implemented.

– Dennis E. Barnedt III, OASIS Group

PERMITTING SUPPORT

Obtaining the necessary permits to begin construction of your racking system is a time-consuming and often frustrating process. Each state and local area has its own set of requirements that projects must meet to obtain approval.

With our building permit preparation and support services, REB Storage Systems International helps you obtain the necessary permits to ensure the on-time implementation of your rack system. We'll help you complete the paperwork, gather the required documentation, and submit your applications to the appropriate authorities.

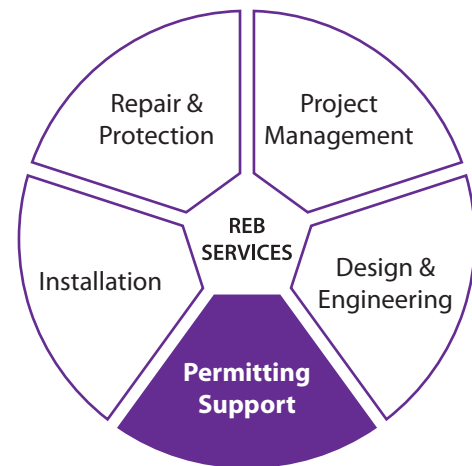

REB has truly been our partner in business and assists us in whatever needs we have including new building design and layout. We always know we are within codes and regulations because of REB's constant industry involvement and relationships.

- Mike Jurczykowski, Chicago Records Storage

TECHNICAL DRAWINGS, APPLICATION ENGINEERING, & STRUCTURAL CALCULATIONS

Our team will research the requirements for the location of your facility including building construction type, sprinklers, zoning, and occupancy classifications. Our engineers will use this data to produce a storage system design that fully meets these regulations.

A licensed project engineer will then prepare and review all drawings, bill of material, and calculation drawings for approval and stamping.

SCHEDULING FOR BUILDING, FIRE, & INSPECTION DEPARTMENTS

After receiving approval for the storage system designs, we'll arrange for building, fire, and other departments to conduct necessary inspections as needed.

BUILDING PERMITS & FINAL OCCUPANCY

We will schedule the system installation as permitted and provide as much continued support as needed until the final occupancy permit is issued.

INSTALLATION

Even the most innovative racking and shelving design is only as good as the quality of the craftsmanship that brings it from the design phase to reality. The role of your racking system to the overall success of your operations makes finding the best professionals to install your new racks and shelves of the utmost importance.

REB's project managers oversee the installation process, troubleshoot solutions, and facilitate completion. We retain quality installers located throughout the country who have experience working in a wide array of environments and can meet the challenges presented by any space to ensure that the job is done correctly and on time.

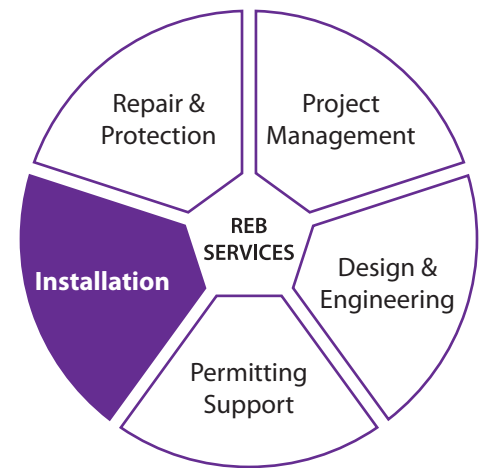

We had a very tight process around the design - far more aggressive than we typically have, and particularly tight around the construction schedule. A normal project of this size should take twelve weeks; we had four, and REB got it done in three weeks.
- David Reyes, Recall

QUALITY STANDARDS

All installation drawings are reviewed by our project engineers to verify compliance with building codes, load applications, rack configuration drawings, and rack component manufacturer's requirements. This is then communicated to our installers so that all specifications are adhered to during the installation process.

PROFESSIONAL CREW

REB certified installers are highly skilled in warehouse rack, shelving, conveyor, and mezzanine installation, configuration, anchorage, reconfiguration, additions and alterations.

Since we are typically installing systems in buildings which must continue ongoing operations, our project managers and subcontractors will work with you in order to minimize the disruption to your day-to-day business while keeping everyone safe.

RACK SYSTEM REMOVAL & RELOCATION

REB has a tremendous amount of experience in the dismantling and repurposing of pre-owned material nationwide. Our crew carefully disassembles racks and shelves without damaging them or the building.

Our team can knockdown, inventory, stack and band the material to and arrange for transport to your new location. We can also reinstall the system at your new location as well as modify or add on to the system if needed.

Conversely, if you are looking to liquidate your current facility or are changing locations and do not need to utilize all of your racking, REB may purchase your used equipment and resell them.

Contact REB Storage Systems International to speak with one of our material handling specialists who can answer any questions you may have regarding your storage requirements.

For more than 50 years, REB Storage Systems International has handled every aspect of racking, shelving, and material handling needs of some of the world's biggest and most successful companies. We are the exclusive racking and shelving designer and installer for many Fortune 500 companies, and have extensive experience designing custom solutions for small and medium businesses. We hope you will invite us to help you.

CONTACT

Please contact one of our specialists below according to your requirements. If you require more than one of the categories found below, please include all inquiries in one request.



STORAGE SYSTEMS & MEZZANINES

Phone: 800-252-5955
Email: storagesystems@rebstorage.com



MATERIAL HANDLING PRODUCTS

Phone: 800-252-5955
Email: mhp@rebstorage.com



RACK INSPECTION, REPAIR, & MAINTENANCE SERVICES

Phone: 800-252-5955
Email: rackrepair@rebstorage.com



MODULAR OFFICES

Phone: 800-252-5955
Email: classicmodular@rebstorage.com

REB LOCATIONS

CHICAGO (HEADQUARTERS)

REB Storage System International
4556 W. Grand Ave.
Chicago, IL 60639
Phone: 773-252-0400
Global Toll Free: 800-252-5955
Fax: 773-252-0303
Email: info@rebstorage.com
www.rebstorage.com

DUBLIN

REB Storage Systems International
Unit 15D Kinsealy Business Park
Kinsealy, Co. Dublin
Ireland
Phone: (+353)-1-685-4860
Email: info@rebstorage.com
www.rebstorage.eu

BRANCH OFFICES

California • Massachusetts • Michigan • New York • Pennsylvania